

FPR Example Comments

Historic Resource-related Comment

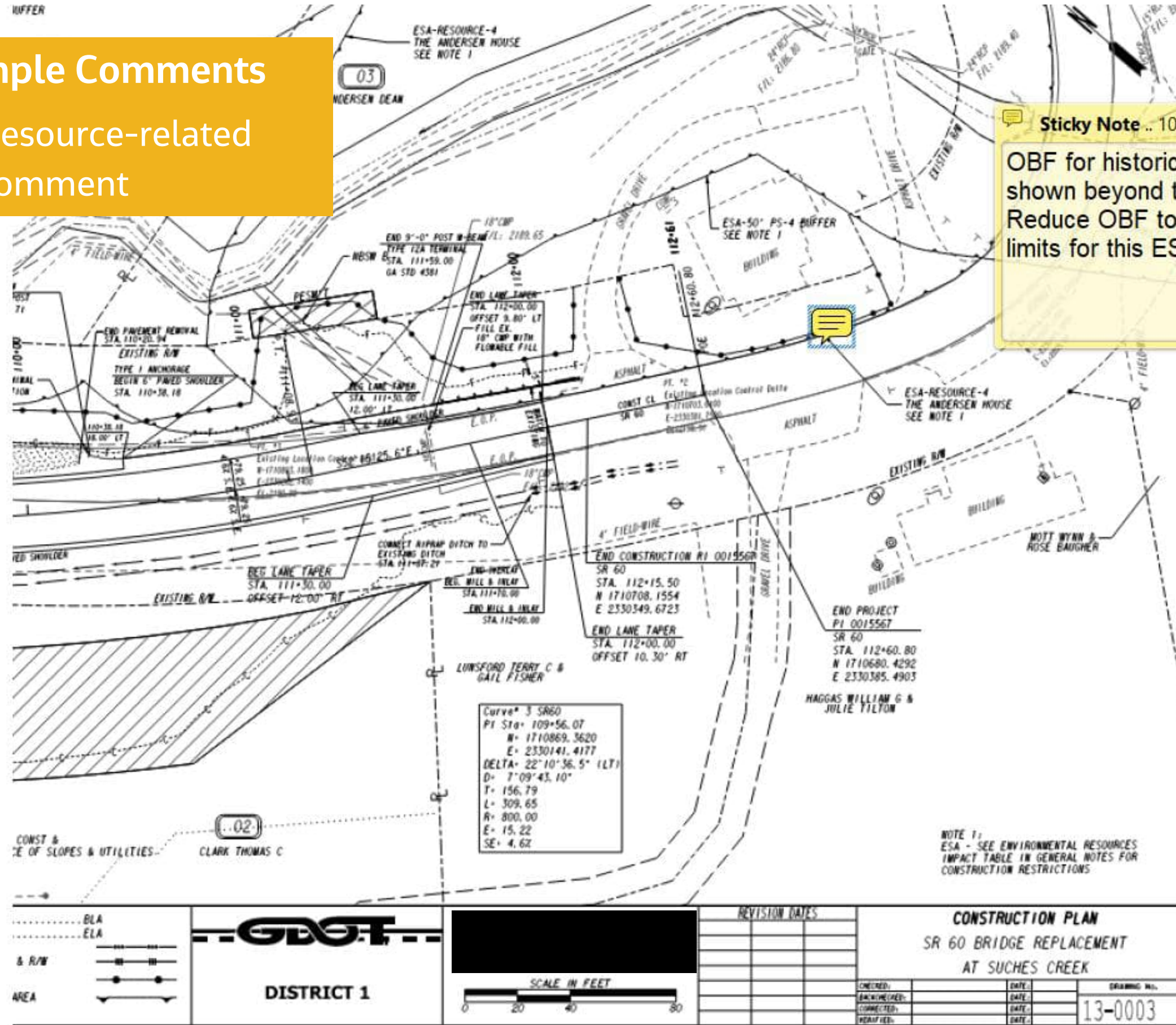

Sticky Note .. 10/26/2023, 10:42:15 AM ×

OBF for historic resource ESA is shown beyond the project limits. Reduce OBF to be within project limits for this ESA.

..... BLA ELA & R/W AREA	 DISTRICT 1	 SCALE IN FEET	REVISION DATES		CONSTRUCTION PLAN SR 60 BRIDGE REPLACEMENT AT SUCHES CREEK	
			CHECKED: DRAWN/REVISION: CORRECTED: REVISION:	DATE: DATE: DATE: DATE:	DRAWING No. 13-0003	

FPR Example Comments

Historic Resource-related Comment

Sticky Note 10/26/2023, 10:28:50 AM X

Milledgeville Historic District ESA boundary should follow the centerline of the creek

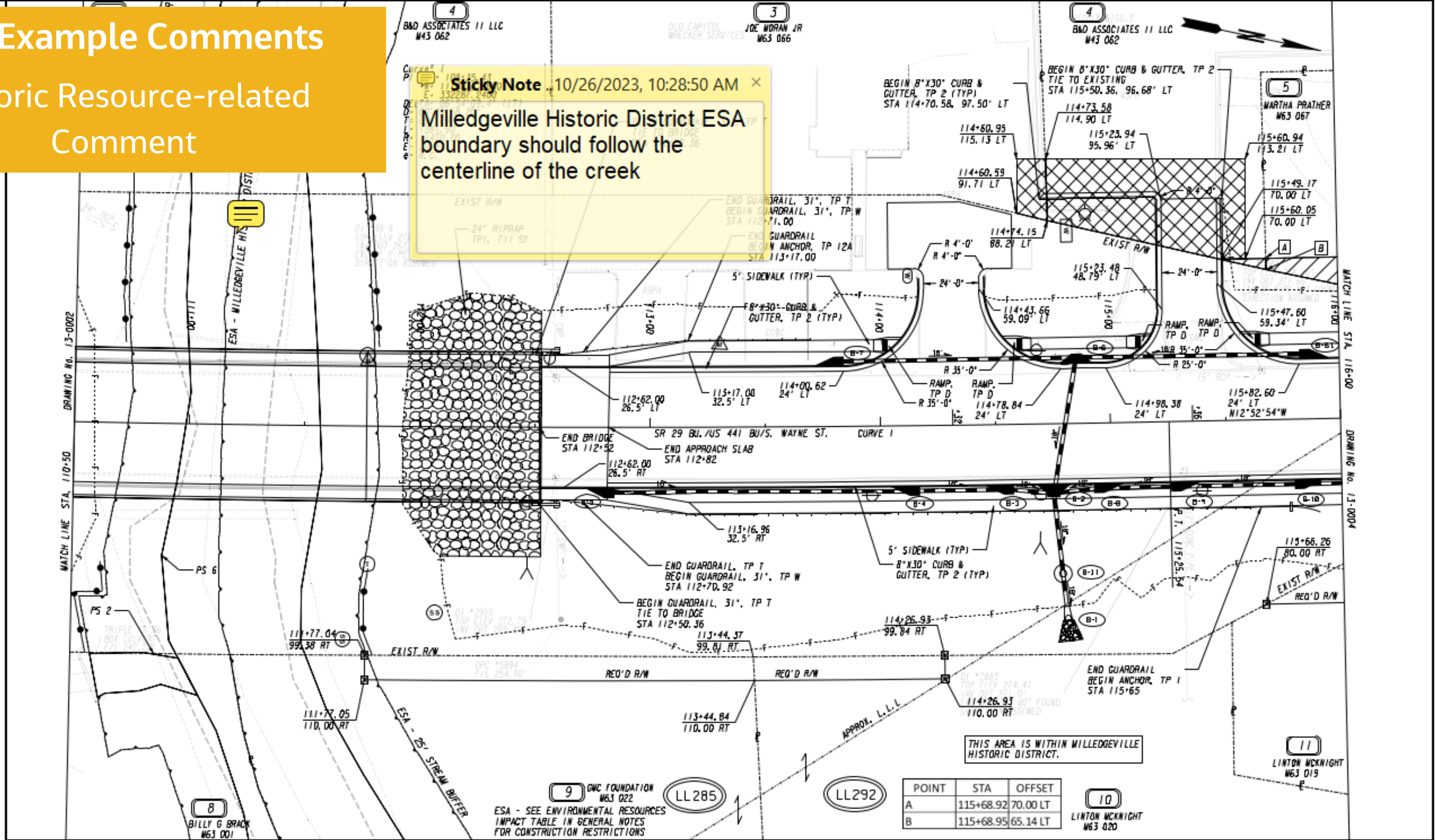

PROPERTY AND EXISTING R/W LINE
 REQUIRED R/W LINE
 CONSTRUCTION LIMITS
 EASEMENT FOR CONSTR
 & MAINTENANCE OF SLOPES
 EASEMENT FOR CONSTR OF SLOPES
 EASEMENT FOR CONSTR OF DRIVES

---E--- BEGIN LIMIT OF ACCESS.....BLA
 ---E--- END LIMIT OF ACCESS.....ELA
 ---C---F--- LIMIT OF ACCESS
 ---H---H--- REQ'D R/W & LIMIT OF ACCESS
 ---X---X--- ORANGE BARRIER FENCE
 ---S---S--- ESA - ENV. SENSITIVE AREA
 (SEE ERIT TABLE)

9 GWC FOUNDATION W63 022
 BILLY G BRACK W63 001
 BND ASSOCIATES II LLC W43 062
 JOE MORAN JR W63 066
 BND ASSOCIATES II LLC W43 062
 WARTH PRATHER W63 067
 LINTON MCKNIGHT W63 019



POINT	STA	OFFSET
A	115+68.92	70.00 LT
B	115+68.95	65.14 LT

REVISION DATES		CONSTRUCTION PLAN	
CHECKED:	DATE:	SR 29 BU/US 441 BU @ FISHING CREEK FROM STA 110+50 TO 116+00	
DESIGNED:	DATE:	DRAWING No. 13-0003	
CONSTRUCTED:	DATE:		
VERIFIED:	DATE:		

FPR Example Comments

Noise Wall-related Comment

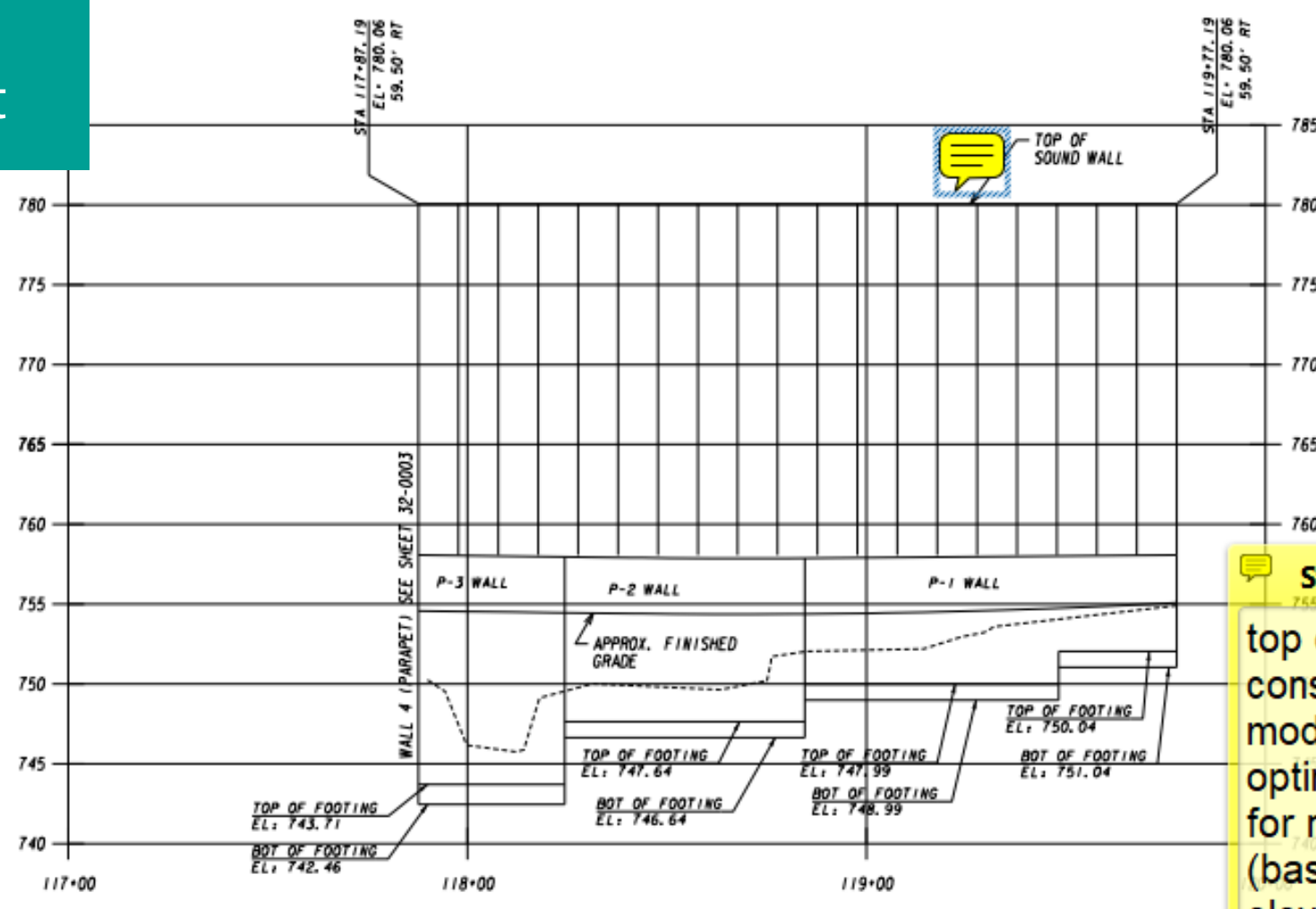

Sticky N.. 6/19/2023, 2:52:02 ..
 top of wall heights are not consistent with the noise models. Please see barrier optimization spreadsheet for noise barrier dimensions (base and top of wall elevations).

WALL 5 (NOISE)
 STA 117+87.19 RT TO 119+77.19
 BARRIER MOUNTED SOUND BARRIER
 SEE GDOT DETAIL N-1A

FFPR PLANS

PROPERTY AND EXISTING R/W LINE	-----e-----
REQUIRED R/W LINE	-----c-----
CONSTRUCTION LIMITS	-----f-----
EASEMENT FOR CONSTR & MAINTENANCE OF SLOPES	[Hatched Box]
EASEMENT FOR CONSTR OF SLOPES	[Hatched Box]
EASEMENT FOR CONSTR OF DRIVES	[Hatched Box]

BEGIN LIMIT OF ACCESS.....BLA	[Symbol]
END LIMIT OF ACCESS.....ELA	[Symbol]
REQ'D LIMIT OF ACCESS	[Symbol]
REQ'D LIMIT OF ACCESS & R/W	[Symbol]
ORANGE BARRIER FENCE	[Symbol]
ESA - ENV. SENSITIVE AREA (SEE ERIT TABLE)	[Symbol]

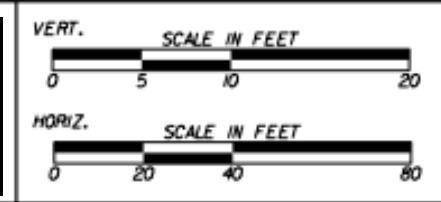
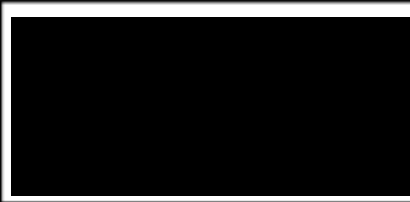

REVISION DATES	

NOISE BARRIER PLANS ROCK QUARRY ROAD		CHECKED:	DATE:	DRAWING No.
		BACKCHECKED:	DATE:	34-0001
CONNECTED:	DATE:			
VERIFIED:	DATE:			

Archaeology (generally below ground cultural resources):

ESB Choose an item.

FPR Example Comments

Noise Wall-related Comment

above:

Noise Walls:

Noise walls Choose an item.

The following revisions are required for noise walls based on the above:

The plans need to be revised to include the correct barrier heights. Also, the engineers shifted the barriers due to design constraints so the coordinates changed, but only the noise models needed to be updated with those. The coordinates in the plans are good. Coordinating with the engineers to ensure consistency between the noise models and the plans.

NEPA (community resources) specifically committed to protect as a result of the environmental process outside of History) and/or UST's if committed to be shown on plans:

Right-of-way limits (including all easements) have been reviewed Choose an item.

Resources: Choose an item.

ERIT Table Choose an item.

The following revisions are required for community resources based on the above:

Special Provisions (NEPA checks across all areas)

Choose an item.

This Field Plan Review Form/Comments need to be sent to the following once completed by OES NEPA Analyst:

- **Engineering Services Coordinators** (the coordinators can be found on the field plan review schedule letter)
- **Copying the NEPA consultant analyst if there is one, all in-house OES specialists, NEPA's Team Leader, Project Manager and Environmental Program Manager.**

FPR Example Comments

Ecology OBF-related Comment

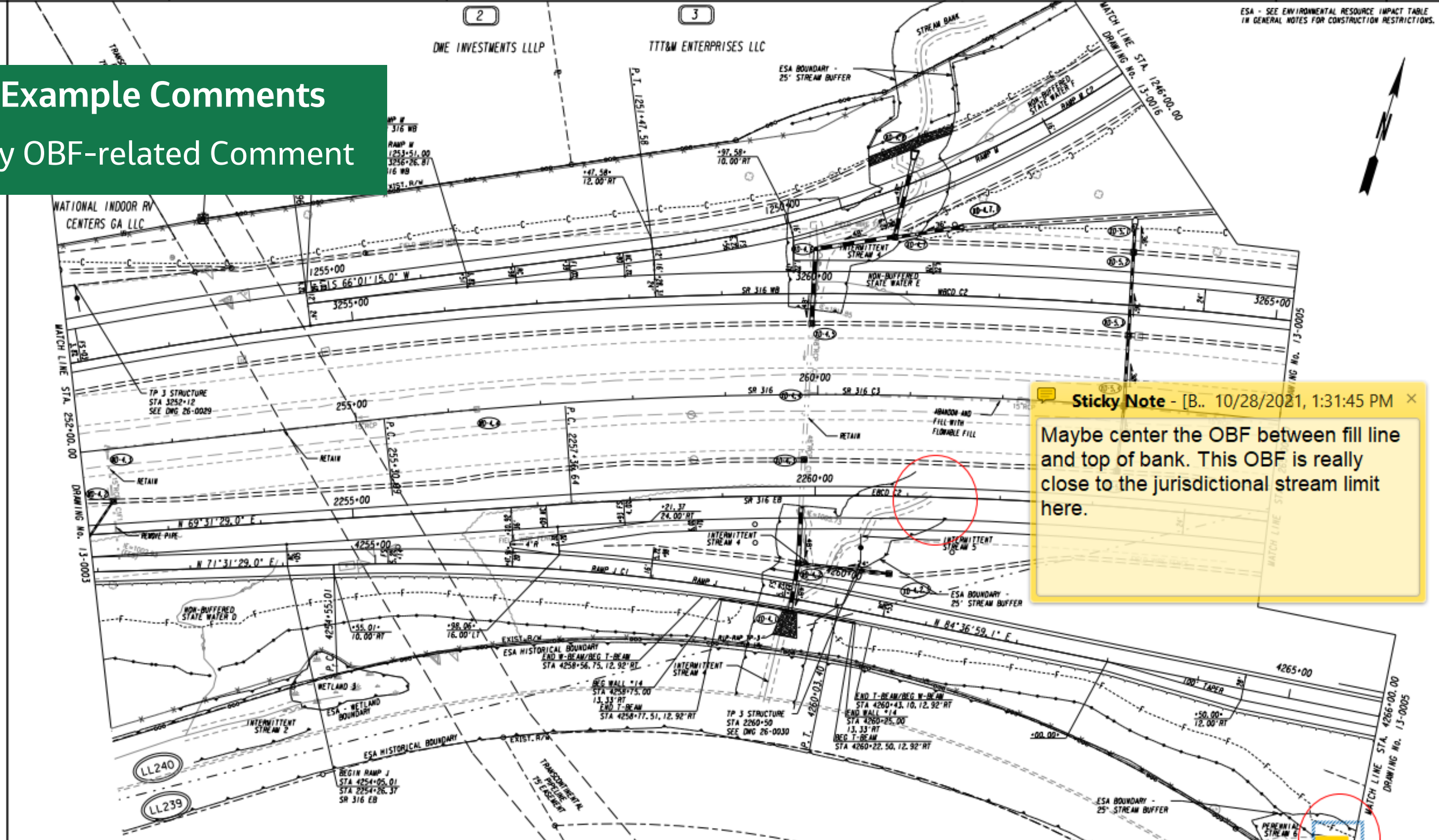

Sticky Note - [B.. 10/28/2021, 1:31:45 PM

Maybe center the OBF between fill line and top of bank. This OBF is really close to the jurisdictional stream limit here.

PROPERTY AND EXISTING R/W LINE	---
REQUIRED R/W LINE	---
CONSTRUCTION LIMITS	---
EASEMENT FOR CONSTR & MAINTENANCE OF SLOPES	---
EASEMENT FOR CONSTR OF SLOPES	---
EASEMENT FOR CONSTR OF DRIVES	---

BEGIN LIMIT OF ACCESS.....BLA	---
END LIMIT OF ACCESS.....ELA	---
LIMIT OF ACCESS	---
REQ'D R/W & LIMIT OF ACCESS	---
ORANGE BARRIER FENCE	---
ESA - ENV. SENSITIVE AREA (SEE ERIT TABLE)	---

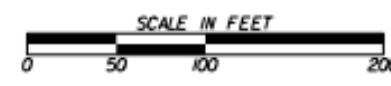

REVISION DATES	

CONSTRUCTION PLAN	
SR 316 FM CEDARS RD TO SUGARLOAF PKWY	
DECEDED:	DATE:
BACHECKED:	DATE:
CONNECTED:	DATE:
VERIFIED:	DATE:
DRAWING No. 13-0004	

FPR Example Comments

Ecology Impact Reduction-related Comment and OBF Related comment

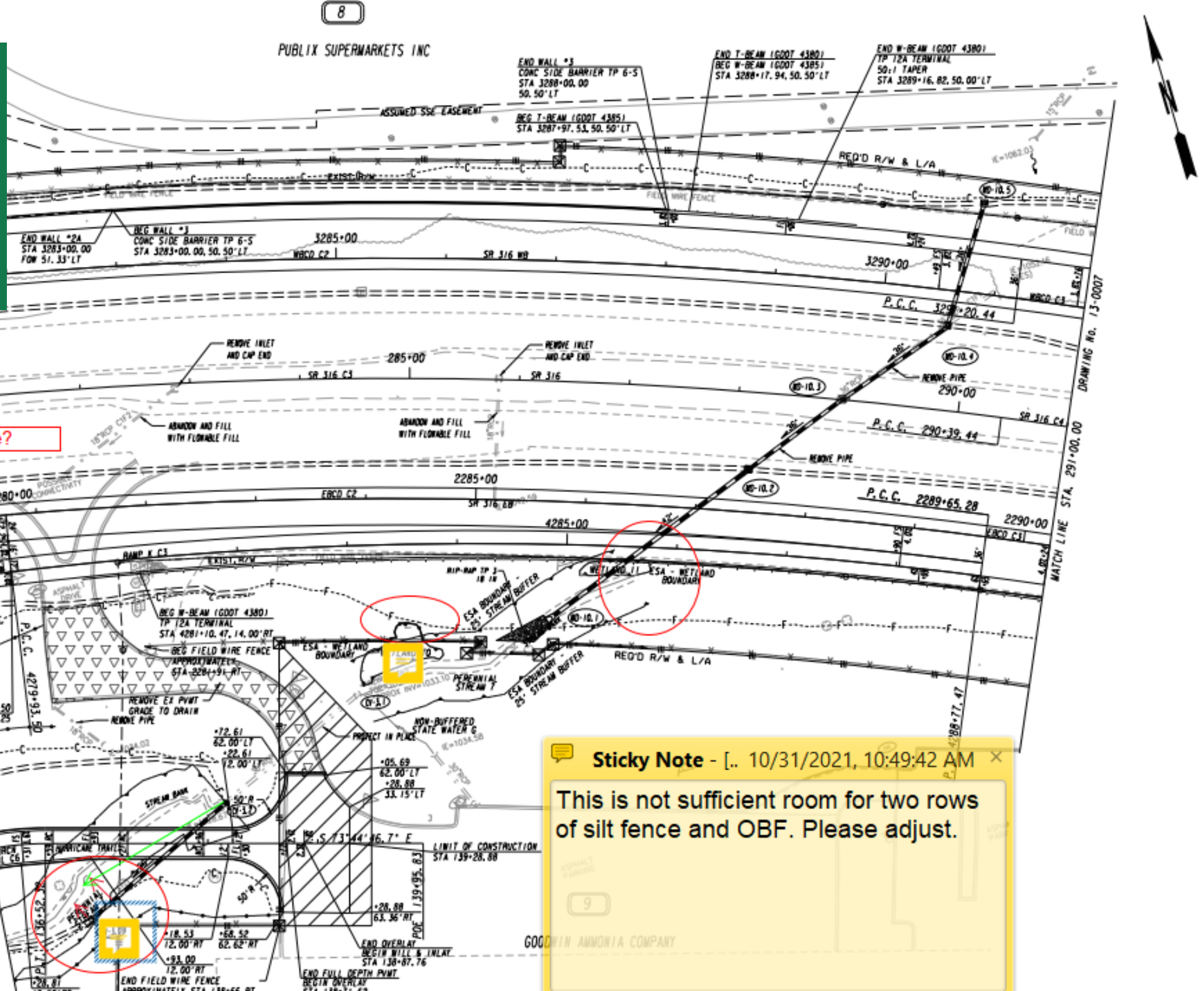

Sticky Note - [10/28/2021, 10:52:56 AM

Could this pipe be aligned to discharge more directly into the stream (as green arrow is indicating)? This would potentially reduce linear feet of impact to PS 7 as well.

Sticky Note - [10/31/2021, 10:49:42 AM

This is not sufficient room for two rows of silt fence and OBF. Please adjust.

PROPERTY AND EXISTING R/W LINE	---	BEGIN LIMIT OF ACCESS.....BLA	---
REQUIRED R/W LINE	---	END LIMIT OF ACCESS.....ELA	---
CONSTRUCTION LIMITS	---	LIMIT OF ACCESS	---
EASEMENT FOR CONSTR	---	RED'D R/W & LIMIT OF ACCESS	---
& MAINTENANCE OF SLOPES	---	ORANGE BARRIER FENCE	---
EASEMENT FOR CONSTR OF SLOPES	---	ESA - ENV. SENSITIVE AREA	---
EASEMENT FOR CONSTR OF DRIVES	---	(SEE ERIT TABLE)	---

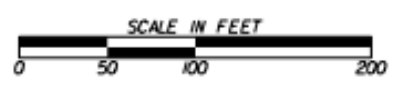

REVISION DATES		CONSTRUCTION PLAN	
		SR 316 FM CEDARS RD TO SUGARLOAF PKWY	
CHECKED:	DATE:	DRAWING No.	13-0006
BACHECKED:	DATE:		
CORRECTED:	DATE:		
VERIFY:	DATE:		

ESA - SEE ENVIRONMENTAL RESOURCE IMPACT TABLE IN GENERAL NOTES FOR CONSTRUCTION RESTRICTIONS.

FPR Example Comments
Ecology Buffer-related Comments

Sticky Note - [B.. 10/29/2021, 2:17:18 PM
 Close off buffers throughout plan set per EPD guidance.

Sticky Note - [B.. 10/29/2021, 2:18:02 PM
 Please square off buffers where streams begin at a headcut or end of a pipe, and round buffers off where the streams begin at a seep.

<p>PROPERTY AND EXISTING R/W LINE REQUIRED R/W LINE CONSTRUCTION LIMITS EASEMENT FOR CONSTR & MAINTENANCE OF SLOPES EASEMENT FOR CONSTR OF SLOPES EASEMENT FOR CONSTR OF DRIVES</p>		<p>BEGIN LIMIT OF ACCESS.....BLA END LIMIT OF ACCESS.....ELA LIMIT OF ACCESS REQ'D R/W & LIMIT OF ACCESS ORANGE BARRIER FENCE ESA - ENV. SENSITIVE AREA (SEE ERIT TABLE)</p>		<p>REVISION DATES</p> <table border="1"> <tr><td> </td><td> </td><td> </td></tr> <tr><td> </td><td> </td><td> </td></tr> <tr><td> </td><td> </td><td> </td></tr> <tr><td> </td><td> </td><td> </td></tr> </table>													<p>CONSTRUCTION PLAN SR 316 FM CEDARS RD TO SUGARLOAF PKWY</p>	<p>CHECKED: _____ DATE: _____ BACKCHECKED: _____ DATE: _____ CONNECTED: _____ DATE: _____ VERIFIED: _____ DATE: _____</p>	<p>DRAWING No. 13-0012</p>

FPR Example Comments

Ecology Buffer and OBF-related Comments

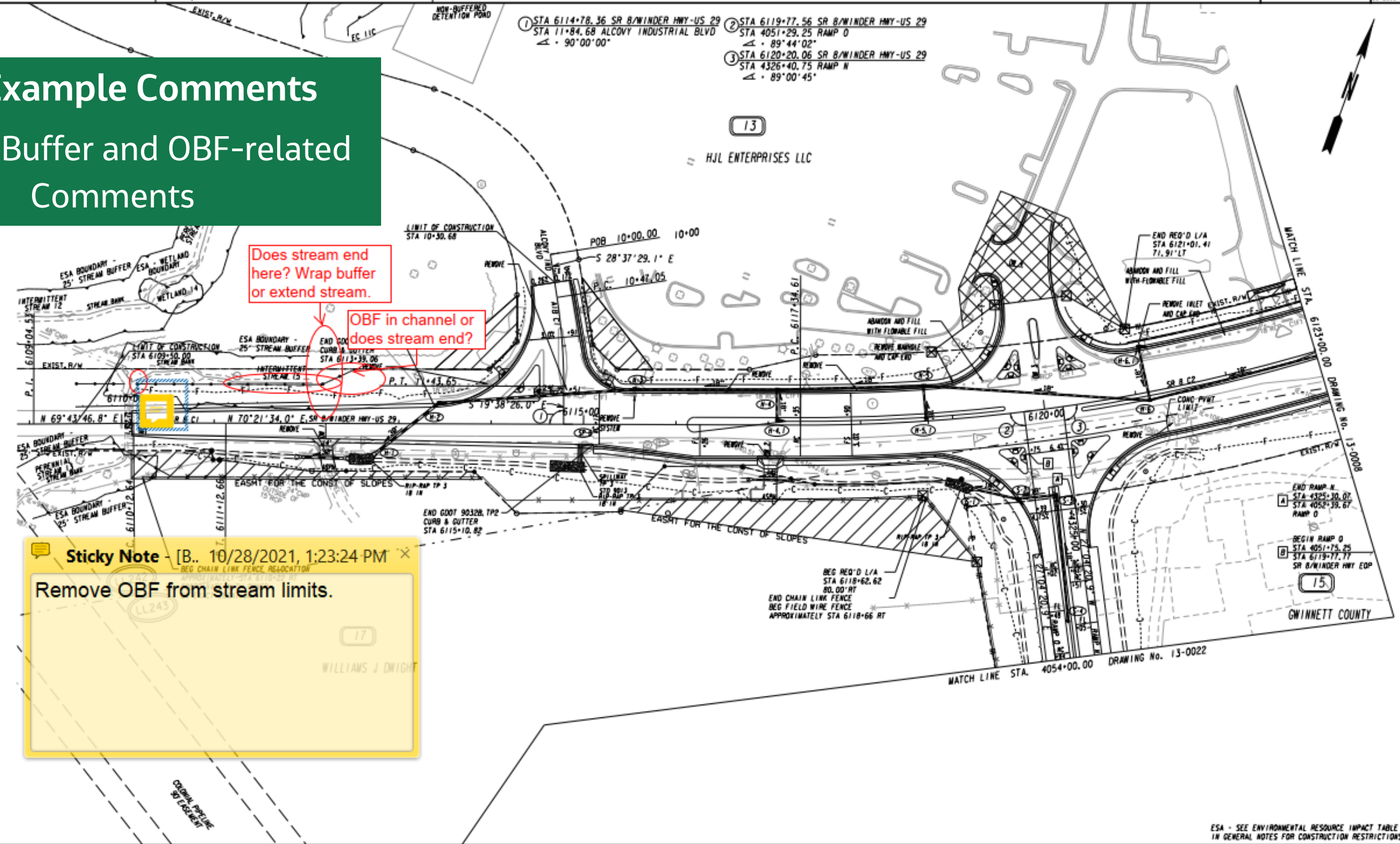

Does stream end here? Wrap buffer or extend stream.

OBF in channel or does stream end?

Sticky Note - [B.. 10/28/2021, 1:23:24 PM] X
 Remove OBF from stream limits.

PROPERTY AND EXISTING R/W LINE	---
REQUIRED R/W LINE	---
CONSTRUCTION LIMITS	---
EASEMENT FOR CONSTR & MAINTENANCE OF SLOPES	---
EASEMENT FOR CONSTR OF SLOPES	---
EASEMENT FOR CONSTR OF DRIVES	---

BEGIN LIMIT OF ACCESS.....BLA	---
END LIMIT OF ACCESS.....ELA	---
LIMIT OF ACCESS	---
REQ'D R/W & LIMIT OF ACCESS	---
ORANGE BARRIER FENCE	---
ESA - ENV. SENSITIVE AREA (SEE ERIT TABLE)	---

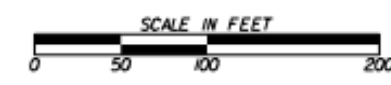

REVISION DATES	

CONSTRUCTION PLAN			
SR 316 FM CEDARS RD TO SUGARLOAF PKWY (SEE 13-0018A FOR ADDITIONAL DETAIL)			
CHECKED:	DATE:	DRAWING NO.	
BACKCHECKED:	DATE:	13-0018	
CONNECTED:	DATE:		
VERIFIED:	DATE:		