

Douglasville, Douglas County SR 92 Relocation & Widening PI#0006900, 0006901, 720970

Georgia Department of Transportation



Dana Lemon

GDOT Board Member
13th Congressional District

Agenda

- Introductions
- Project History
 - Obstacles
 - Next Steps
 - Q & A
 - Wrap-Up

Albert Shelby

Director of Program Delivery

Kathy Zahul

District Engineer District 7

Project History

SR 92 Relocation & Widening

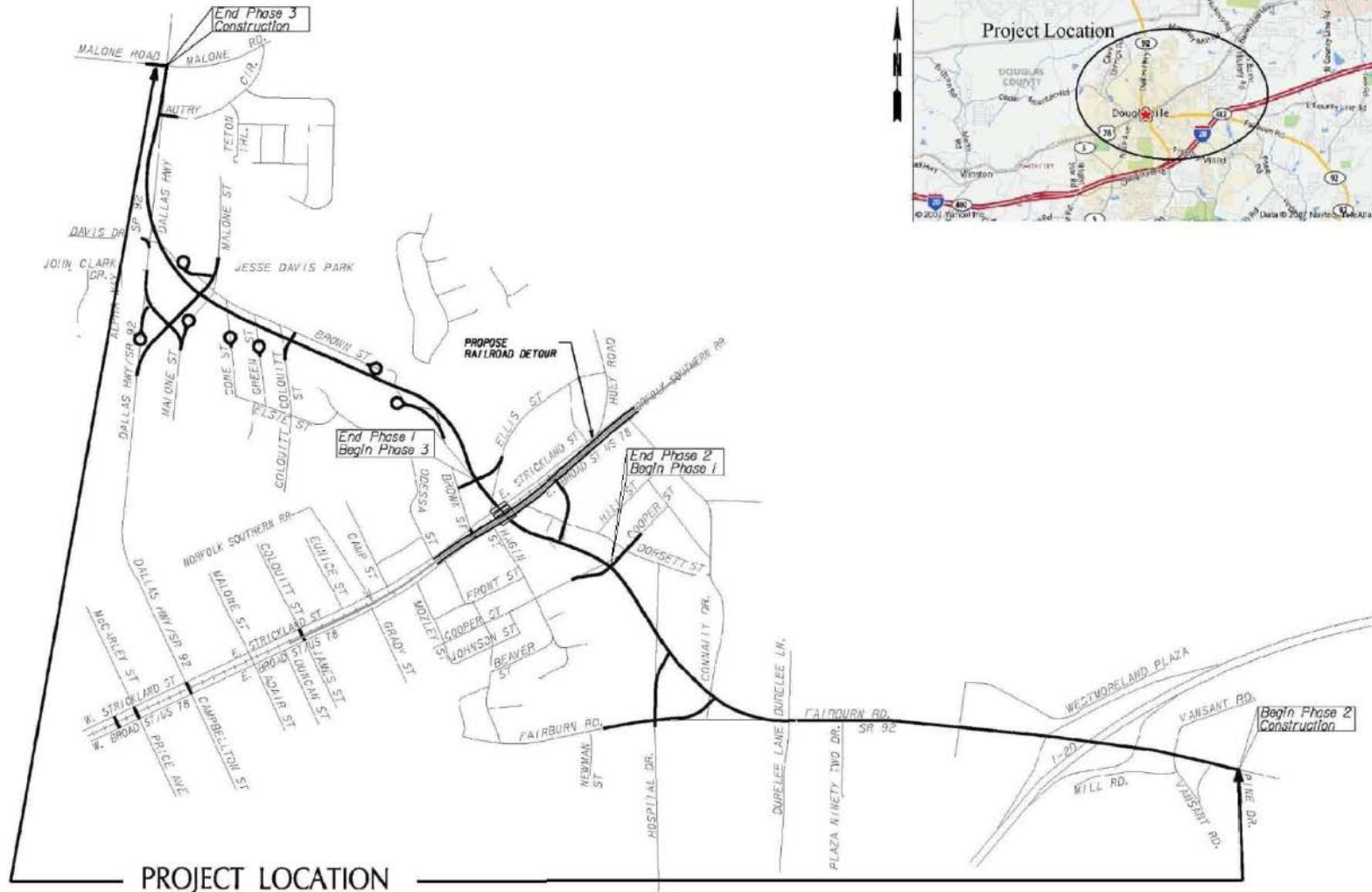

SR 92 Relocation & Widening

- Project Phases Information:
 - **Downtown Douglasville - Phase I (PI#0006900), Project Length: 0.33 miles**
 - SR 92 Relocation from Cooper Street to Ellis Street Relocation, Including Bridge Underpass (three bridges at US 78/Bankhead Highway, Norfolk Southern RR, and Strickland Street) & Norfolk Southern Rail Road Crossing Closures
 - **Douglasville Commercial District - Phase II (PI#0006901), Project Length: 1.43 miles**
 - SR 92 Relocation from south of I-20 (Pine Drive) to Cooper Street Relocation
 - **Douglasville Residential District - Phase III (PI#720970-), Project Length: 1.34 miles**
 - SR 92 Relocation from Ellis Street Relocation to North of Malone Road
- Construction Percent Complete: **64% as of May 2018**
- Estimated Completion Date: **November 2020**

Obstacles to Completion

3 bridges to be built



Bridges location



The Railroad Bridge

NS RR Detour Tracks

- Amount of Rock to be blasted and excavated from an elevation point of view:
- Depth: up to 30'
- Width: up to 244'

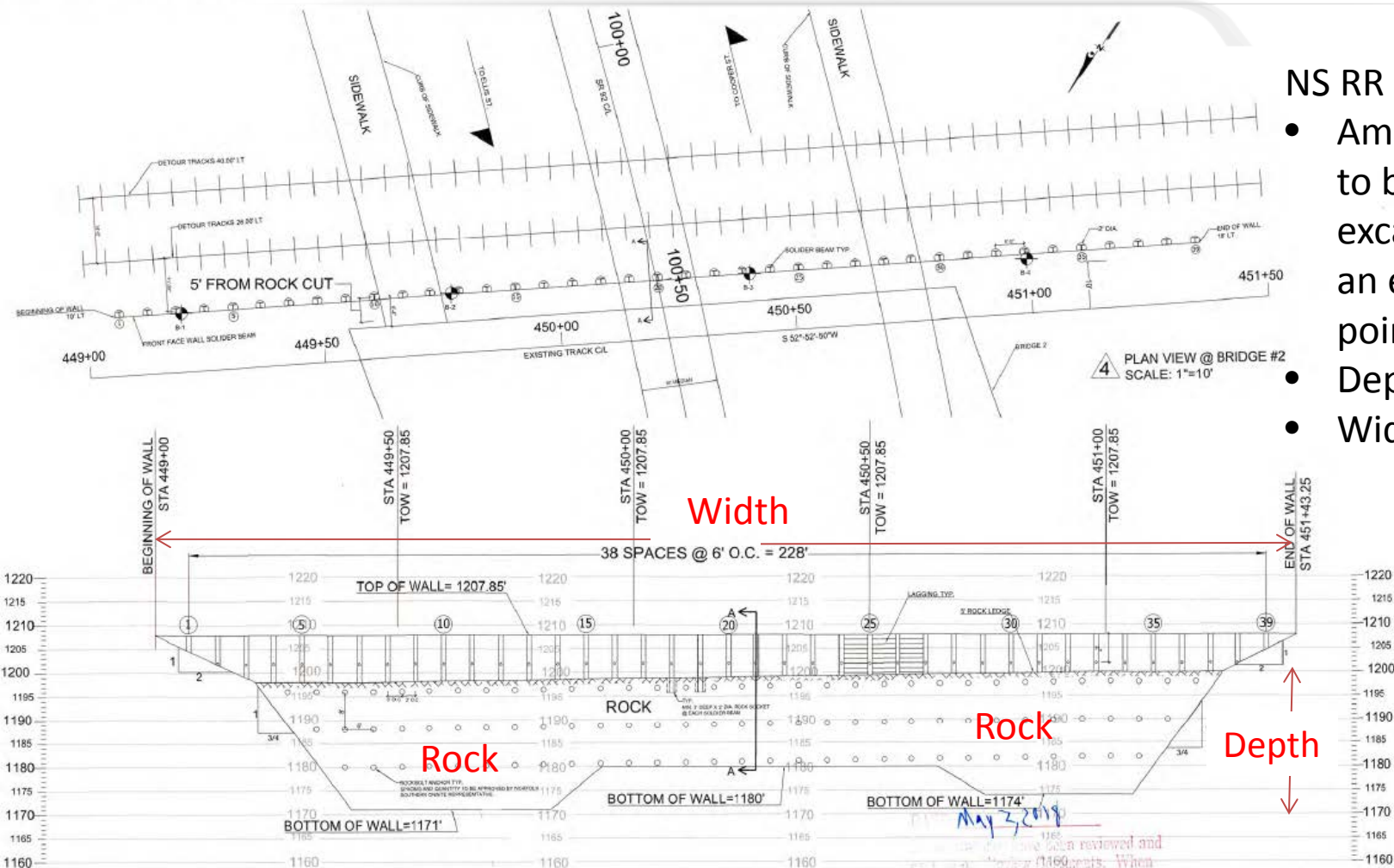

The plan view of Bridge 2 shows a rectangular bridge structure with two abutments. Key features include:

- Abutment 1 (Left):** Labeled 'B.F.P.R. ABUTMENT 1' and '80°-00'-00" TYP.'. It is the 'BEGIN BRIDGE STA. 903+77.50'.
- Abutment 2 (Right):** Labeled 'B.F.P.R. ABUTMENT 2' and 'END BRIDGE STA. 905+00.00'.
- Bridge Deck:** The main span is labeled 'CONST. & P.G.L. EAST STRICKLAND ST.' with a bearing of 'N 55°-28'-49" E'. A 'POINT OF MIN. VERT. CLEARANCE' is marked on the left side of the deck.
- Approach Roads:**
 - SR 92:** Approaches from the left, with a '80°-15'-45.6" TO LOCAL TANGENT' and 'CONST. & P.G.L. SR 92'.
 - Huey St.:** Approaches from the bottom, with a '1°-7 1/2" TO HUEY ST.' and 'CONST. & P.G.L. SR 92'.
- Front Face Walls:** 'FRONT FACE WALL 5' on the left and 'FRONT FACE WALL 4' on the right.
- Medians and Sidewalks:** A 'RAISED MEDIAN' is shown between the bridge deck and SR 92. Sidewalks are dimensioned as '10'-0" R. SIDEWALK' and '13'-0" R. SIDEWALK'.
- Other Dimensions:** Various offsets and widths are noted, such as '37'-0" R.', '16'-0" R.', '8'-0" R.', '5'-6" SIDEWALK', '1'-2 1/2"', '6'-8 1/2"', '1'-0" 2"', '14'-0" 2"', and '1'-7 1/2"'. A 'TO COOPER ST.' arrow points towards the top left.
- Stationing:** 'STA. 904+37.67 EAST STRICKLAND ST. = STA. 10+72.20 SR 92' is indicated.



Length

Width

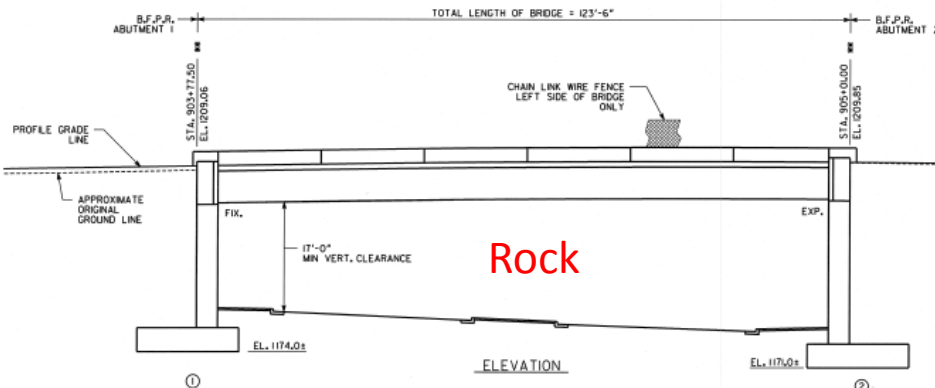

Amount of Rock to be blasted and excavated:

Depth: up to 39'

Length: up to 37'

Width: up to 124'

Depth

The Bankhead Highway Bridge

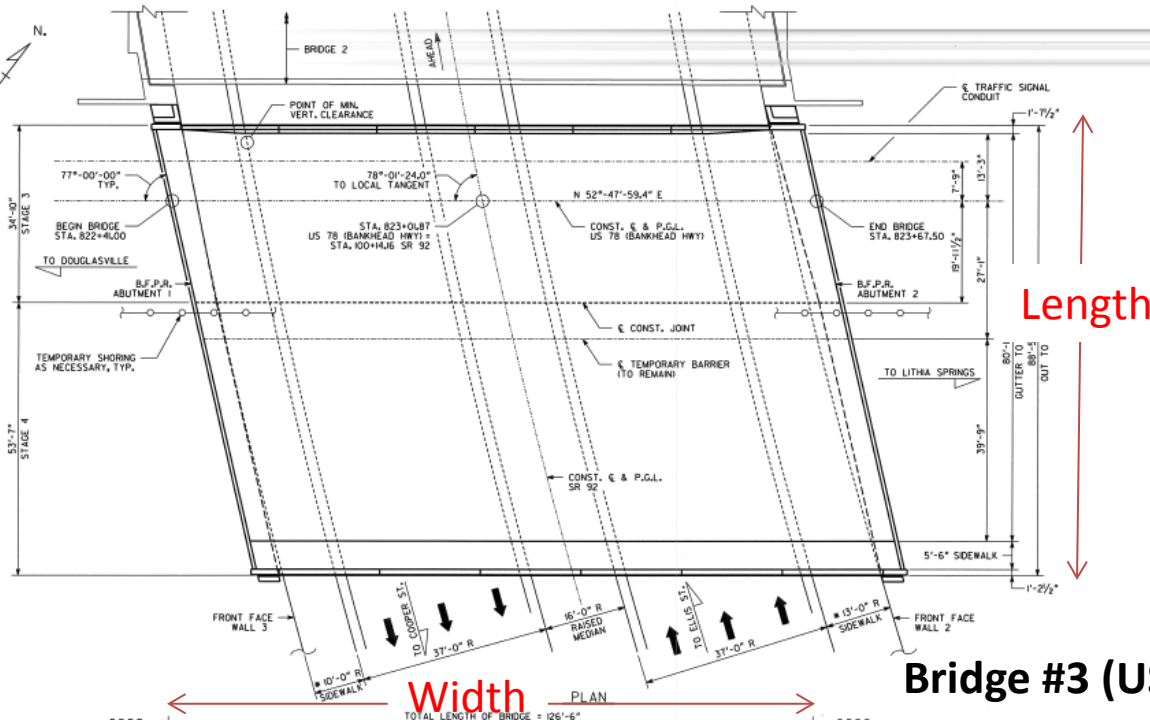

Bridge #3 (US 78/Bankhead Highway over SR 92)

Amount of Rock to be blasted and excavated:

Depth: **up to 41'**

Length: **up to 89'**

Width: **up to 128'**

Depth

Next Steps

SR 92 Relocation & Widening

Truck Detour Due to Mozley St. RR Crossing Closure

On-System Truck Detour

From US 78/Bankhead Hwy to US 278/SR 6/Thornton Rd/CH James Pkwy/Wendy Bagwell Pkwy to SR 92/Dallas Hwy

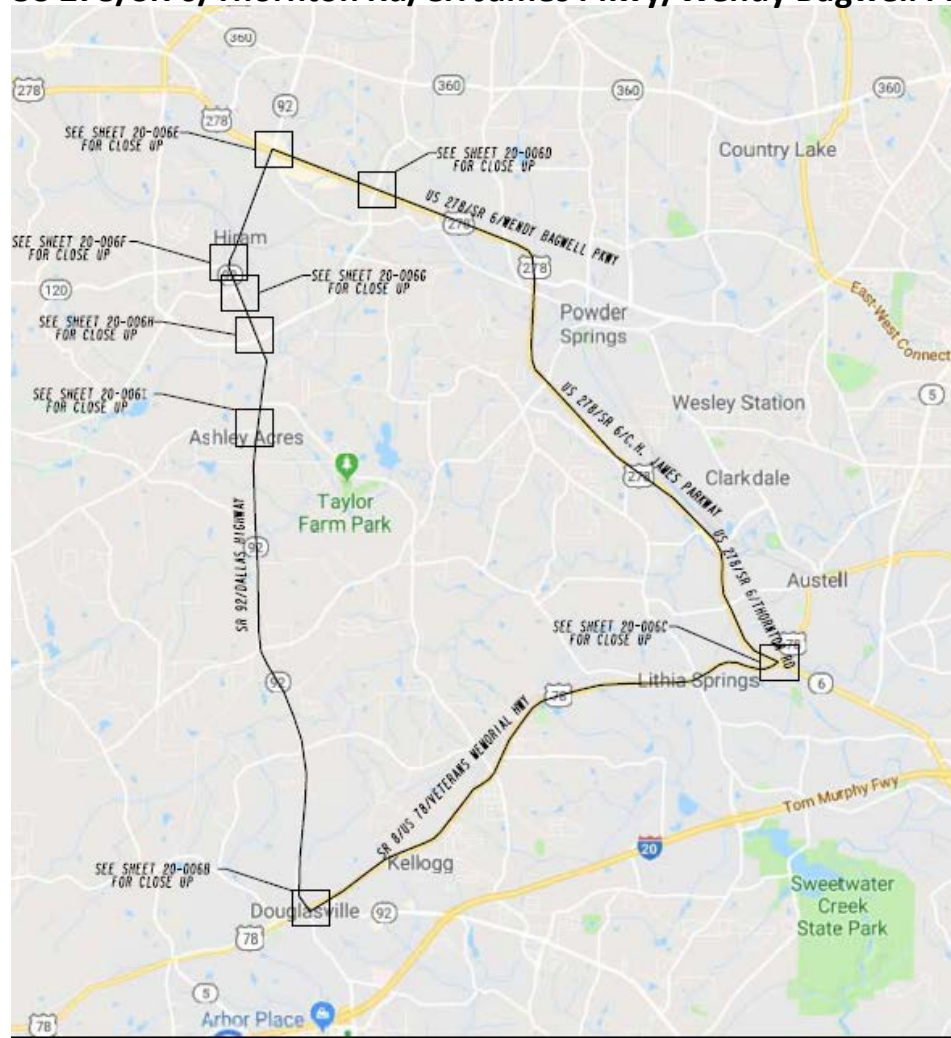

General Information

- **Project websites**

- GDOT: www.dot.ga.gov/BS/Projects/SpecialProjects/SR92
- Douglasville: <https://www.douglasvillega.gov/730/Georgia-Highway-92-Relocation-Project>

- **City and GDOT project contacts**

- City contact: Marcia Hampton, City Manager, email address: hamptonm@douglasvillega.gov, phone #: 678-449-3022
- GDOT contact: Lankston Johnson, Area Manager, email address: ljohnson@dot.ga.gov, phone #: 404-559-6699

Q & A