

SEQUENCE OF ROAD CLOSURES

CLOSURES REQUIRED TO BEGIN CONSTRUCTION:

DORSETT STREET
GREEN STREET
CONE STREET
BROWN STREET RR CROSSING
HOSPITAL DRIVE NORTH

CLOSURES REQUIRED APPROX. TWO WEEKS
AFTER CONSTRUCTION BEGINS:

BROWN STREET NORTH
BROWN STREET SOUTH
E STRICKLAND STREET
COOPER STREET

NOTICE
ROAD WILL
BE CLOSED
XX-XX-XX

THIS SIGN SHALL BE PLACED
ON ALL ROADS THAT ARE TO BE
CLOSED A MINIMUM OF ONE WEEK
PRIOR TO THE DATE OF CLOSURE.

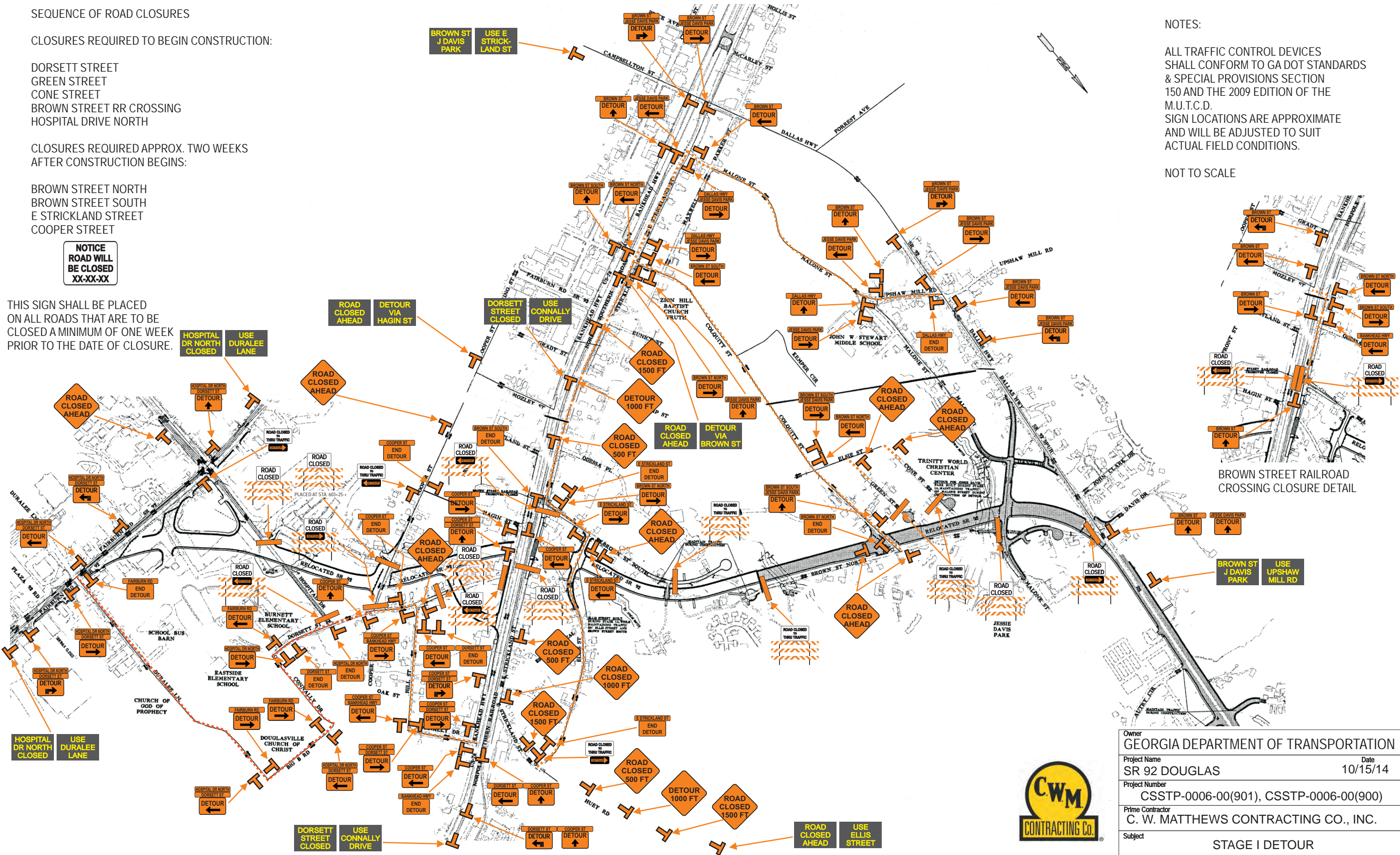

NOTES:

ALL TRAFFIC CONTROL DEVICES
SHALL CONFORM TO GA DOT STANDARDS
& SPECIAL PROVISIONS SECTION
150 AND THE 2009 EDITION OF THE
M.U.T.C.D.
SIGN LOCATIONS ARE APPROXIMATE
AND WILL BE ADJUSTED TO SUIT
ACTUAL FIELD CONDITIONS.

NOT TO SCALE

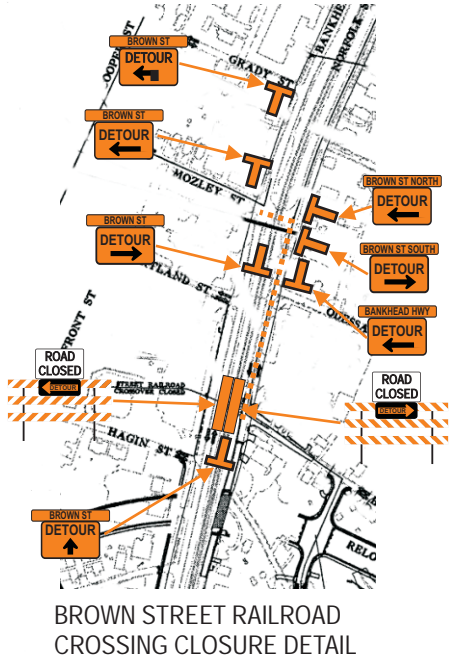

Owner GEORGIA DEPARTMENT OF TRANSPORTATION	
Project Name SR 92 DOUGLAS	Date 10/15/14
Project Number CSSTP-0006-00(901), CSSTP-0006-00(900)	
Prime Contractor C. W. MATTHEWS CONTRACTING CO., INC.	
Subject STAGE I DETOUR	